

# SVS1413-21 VOLTAGE STABILISER

## VOLTAGE STABILISATION AND PROTECTION FOR ALL ELECTRICAL AND ELECTRONIC EQUIPMENT

### DESCRIPTION

The SVS1413-21 is a precise voltage stabiliser designed to protect your appliances against the harmful consequences of an unpredictable power supply, ensuring optimal performance and extending the appliance life. It operates at input voltages of 127 V and 220 V, delivering regulated output voltages of 115 V and 220 V with a precision of  $\pm 6.5\%$ , enabling a stable power supply for your appliances. If the supply voltage becomes too extreme for the SVS to provide a safe output to your appliance, it will disconnect the supply.

The front panel meter displays the two output voltages, and a dedicated button facilitates easy switching between them. Additionally, LED status indicators and digital display keeps you informed, indicating whether the output is in good condition, experiencing issues, or awaiting reconnection after a disconnect event. The SVS1413-21 is designed to provide a seamless and protective power experience with user-friendly features.

### APPLICATIONS

The SVS1413-21 is suitable for all electrical and electronic appliances, including: larger fridges and freezers as well as combinations of TV, satellites and computers.

### FEATURES

- Microprocessor controlled stabiliser
- Extremely fast response
- Solid state with no moving parts
- Very wide input voltage range (150 V - 300 V)
- Excellent output voltage stability ( $\pm 6.5\%$ )
- Includes surge and spike suppression and protection
- Incorporates over & under voltage disconnect (AVS™ function) when mains is extreme and outside working limits
- Startup delay to allow neutralisation of compressor gases, critical in such applications
- Incorporates TIMESAVE™ Function (10 second start-up delay after long duration powercut)
- Frequency and voltage measurement smoothing via software to filter noise
- Digital display for input and output voltage

Always ensure that the current rating of your appliance does not exceed the current rating of the corresponding SVS model.

\*14 Amps and 3000 VA ratings apply to the SVS1413 at a nominal voltage of 220 V



### FEATURES

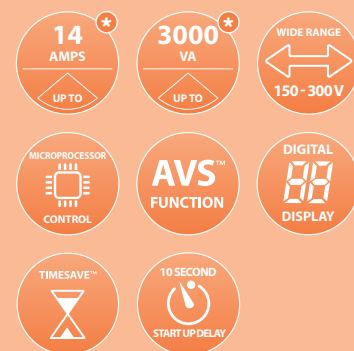

### PROTECTION AGAINST

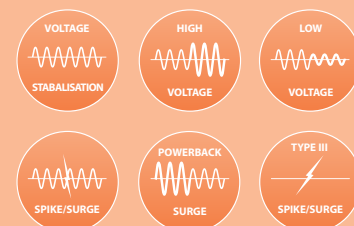

### PROTECTION FOR



## TECHNICAL SPECIFICATION

INPUT & OUTPUT			
Nominal Voltage		220 V	115 V
Input Voltage		127 V or 220 V	
Stabilisation	Input	-26% + 19%	-26% +19%
	Output	+/- 6%	+/-6%
Over Voltage	Disconnect	249 V	N/A
	Reconnect	247 V	N/A
Under Voltage	Disconnect	177 V	92.5
	Reconnect	187 V	97.5
Frequency Range		45 to 75 Hz	
Load Current		14 A	13 A
GENERAL			
Derating Factor	10% to 15% per 10°C above 40°C		
Synchronisation	Output synchronised to input		
Permissible Overload	1000% for 100ms, 150% for 4 minutes, 110% for 15 minutes		
Load Types	Fridges, Freezers, TV, Multimedia, Satellites, IT Equipment, Computers and A/C		
Status Indicator	Digital Display, 2 LED Voltage Indicators 3 LED Status Indicators		
Technology	Transformer tap switching using relays		
Efficiency	>97% (at 100% linear load)		
Control	Micro-controller based control system provides self checks, system integrity, monitoring and diagnostic indicators		
Control Protection	Internal surge arrestors and filters in control circuit protect against disturbances. Filtering algorithms and fault tolerant software protect against disturbances and false measurements		
Ambient Temp Range	0°C to 55°C		
Relative Humidity	< 95%, non condensing		
Acoustic Noise	< 45 dB (A)		
Expected Service Life	> 10 years		
Standards	CE, EN 61558-1, EN 61558-2-13, EN 55014-1, EN 61000-3-2, EN 61000-3-3, EN 61000-4-2, EN 61000-4-3, EN 61000-4-4, EN 61000-4-5, EN 61000-4-6, EN 61000-4-11		
Correction Speed	750 Volts per second		
Response	Within 0.1 second		
Wait Time on Start Up	10 s		
Power Factors	Unaffected by load power factor		
AVS™ Function	Automatic voltage switcher: output is switched off to protect device against over and under voltage and automatically reconnects when safe		
TimeSave™ Function	Reduced startup delay if unit was off for more than the standard delay period to 10 seconds		
MECHANICAL			
Connection	Plug and Socket		
Unit Dimensions WxHxD	340 x 320 x 380 mm		
Unit Weight	23.0 kg		
Packing	Carton	Pallet	
Dimensions WxHxD	370 x 360 x 420 mm	1200 x 800 x 970 mm	
Quantity	1 carton (1 units)	1 pallet (12 cartons)	
Weight	24.2 kg	291.0 kg	

## VOLTAGE TABLE

INPUT	OUTPUT		POWER		
	220 V O/P	115 V O/P	@ 220 V	@ 115 V	Combined
0-80	OFF	OFF			
90	197	103			
100	219	115			
110	215	111			
120	208	109			
130	225	118			
140	216	111			
150	231	119			
160	202	106			
180	227	119			
200	225	116			
220	220	115			
240	214	111			
260	231	120			
270	240	124			
280	OFF	129			
290	OFF	OFF			

■ Max Power Output: 1500 VA

■ Max Power Output: 3000 VA

All weights and dimensions are approximate. Specifications are subject to change without prior notice. © Sollatek (UK) Limited 2024. All Rights Reserved.



## DIMENSIONAL DIAGRAM

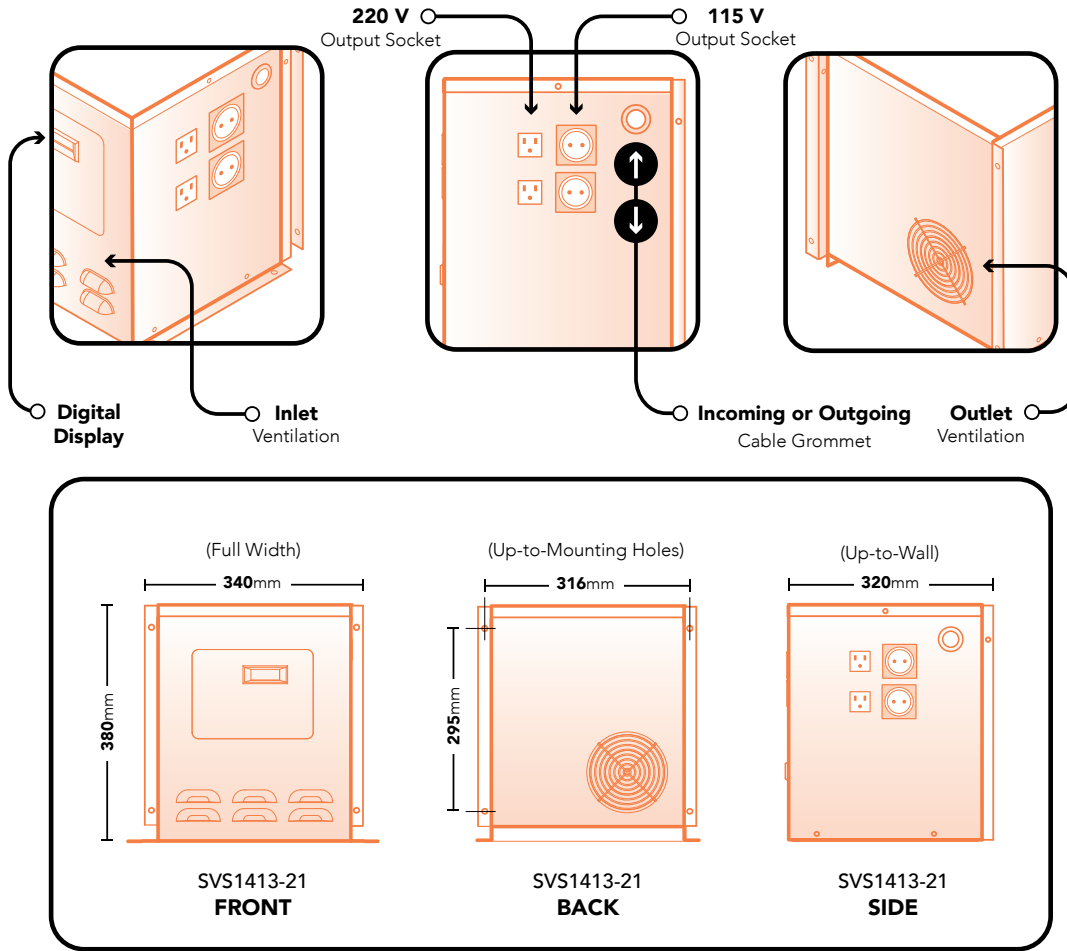

**i** The diagrams presented are for illustrative purposes only. Detailed drawings are available upon request.

PRODUCT CODE	DESCRIPTION
98141321	SVS1413-21-WALL MOUNT DUAL VOLTAGE

**SOLLATEK (UK) LIMITED**  
 Sollatek House, Waterside  
 Drive, Langley, Slough SL3 6EZ,  
 United Kingdom  
 Tel: +44 (1753) 214 500  
 Email: sales@sollatek.com  
 Web: www.sollatek.com

ISO9001: 2015 accredited company  
 All weights and dimensions are  
 approximate. Specifications are subject  
 to change without prior notice. ©Sollatek  
 (UK) Limited 2024. All Rights Reserved.  
 SOLLATEK and the SOLLATEK device are  
 the trade marks of the Sollatek group of  
 companies.

